



# Queensland Rogaine Association

## Tarpaulin parts list and set-up instructions

### Parts list

Tarp in blue bags		Tarp in yellow bags	
1 main bag containing	1 tarpaulin 9 m by 7 m c/w two tie down ropes	1 main bag containing	1 tarpaulin 9 m by 7 m c/w two tie down ropes
2 pole bags containing	16 adjustable 7' poles 8 adjustable 9' poles 3 adjustable ridge bars	2 pole bags containing	16 adjustable 7' poles 8 adjustable 9' poles 3 adjustable ridge bars
1 rope bag containing	4 double guy ropes c/w spring tensioners 18 single guy ropes c/w spring tensioners	1 rope bag containing	26 single guy ropes c/w spring tensioners
1 peg bag containing	8 steel pegs – 18" 20 steel pegs – 12"	1 peg bag containing	8 steel pegs – 18" 20 steel pegs – 12"

### To join the two tarps:

- 3 adjustable poles c/w bolt & nut (orange marked)
- 2 sets – bolts, nuts and washers

### Set-up instructions

- The set-up area must be at least 12 metres long by 10 metres wide, reasonably flat and cleared of rocks, sticks, suckers etc.
- Take the folded tarp out of its bag and lay it down 1.5 metres from one end and on the centreline of the cleared area (refer Sketch 1.) Unfold the tarp lengthwise then widthwise with the top up (the underside has reinforcing lugs at each hole.)
- Once the tarp is laid out flat, lay out and drive 2 off 18" pegs at each corner of the tarp and 1 12" peg at each side hole, one metre from the holes and perpendicular to the tarp (refer Sketch 2.) Leave room between the peg and the ground to hook the guy springs.
- Place guy ropes at each peg; double ropes at corners, singles at side pegs, hooking the springs over the peg.
- Place 7' poles at each corner and end hole and at the two side holes adjacent to each corner. Place 9' poles at the remaining side holes – three per side.
- Extend the corner and end poles to the first black mark and secure. Extend the remaining (side) 7' poles to their second black mark and secure. Extend the two 9' poles next to the 7' poles to their first black mark and secure.
- Starting at one end, raise two corners (if any breeze is blowing start at the windward end) and loosely tension the corner guy ropes, then raise the four poles at that end, lightly tensioning the guy ropes. Repeat for the other end. Raise the 7' side poles and the 9' side poles, loosely tensioning the guy ropes. Repeat for the other side.
- Take the four 9' centre poles and three ridge bars and assemble together on the ground under the raised tarp. Extend the poles to their second (top) black mark; all four must be the same length. The ridge bars are extended, with the adjusting screws loose, **ensuring the screws are not facing upwards with the risk of damaging the tarp**. Refer Sketch 4 for assembly.

## Set-up instructions (cont.)

- With helpers, one person per pole, raise the assembly of centre poles and ridge bars together into position. Extend and secure the ridge bars and loosely tension the guy ropes.
- Align all poles so they are vertical; adjust lengths as necessary; drive all pegs fully and tension all guy ropes. The sides should form an apex as Sketch 3.
- Drive a peg near each of the two centre poles, at an angle of 45°. Attach and tension the ropes hanging down from the tarp to each peg.
- **To pull down and pack.** Follow the above instructions in reverse order and ensure that parts are packed in their respective bags. The tarp is folded widthwise corners to centre, then a third over and over again. Lengthwise, start with approximately 30 cm and fold one way only to the other end. The tarp should fit snugly into its bag.
- **To join the two tarps together.** The area must be at least 17 m by 12 m. The tarps join side to side at the corner marked with the asterisk (\*). At the join, instead of using the normal poles, guy ropes and pegs, use the three poles marked orange. With the tarps on the ground, join at the holes nearest the corners using the 7' joining poles by threading the bolt through the flat washer and the holes and screwing it back into the end of the pole. Do the same at the centre of the join using the 9' joining pole and at the remaining holes with the bolts, nuts and washer sets. Raise as previously described, with helpers taking care of the joining poles.

Parts index	
1	7' pole
2	9' pole
3	ridge bar
4	guy rope
5	18" peg
6	12" peg

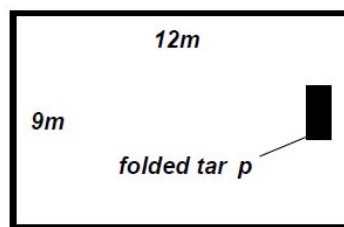

Sketch 1

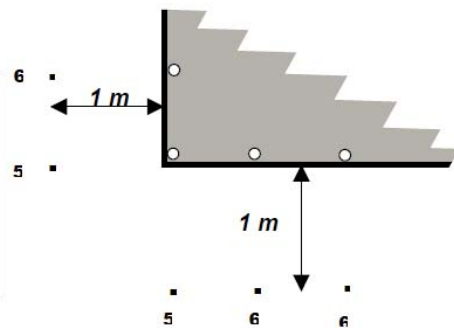

Sketch 2

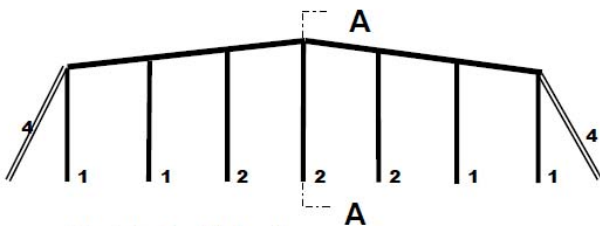

Sketch 3 - Side view

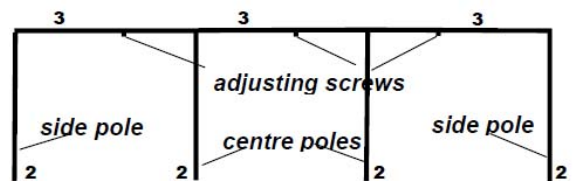

Sketch 4 - View AA